

Euro Banknote Verifier Operation Manual

This banknote verifier is specially designed to detect Euro banknote.

1. START UP:

Connect the machine with prescribed power source (output power: 9V 500mA). The blue light indicates the machine has been successfully started and entered standby state at the same time.

2. DETECTING PROCESS:

- 2.1 Insert vertically a piece of Euro banknote with its front side facing towards the operator.
- 2.2 Ensure the banknote touches completely the back of the slot, and then slide the banknote down to the bottom. (see Fig. 1)

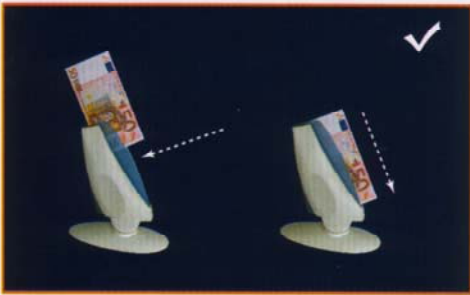

Fig. 1



Fig. 2

NOTE:

1. Wrinkled banknotes must be flattened before inserted in to avoid wrong detection.
2. Do not push the banknote any more when it has reached the bottom of the slot.
3. Both the insertion direction of the banknote are wrong shown as Fig 2

3. DETECTING INSTRUCTION:

- 3.1 Green indicator light together with long beep indicates real banknote.
- 3.2 Flashed red indicator light together with short pulsating beep indicates suspect banknote.
- 3.3 Blue indicator light indicates that the banknote hasn't reach the proper position or the insertion action is too slow or there is defect on the banknote.

4. SOUND SIGNAL ADJUSTMENT:

Ensure the adjusting process is under standby state and there is no banknote in the slot. Use pen point or something alike touch lightly the button under the indicator light. There are two modes available: with beep or without beep:

5. SPECIAL INSTRUCTION:

Under some particular conditions (e.g. a real Euro banknote detected as a suspected one), please follow the above steps to check once again.



Fig. 3

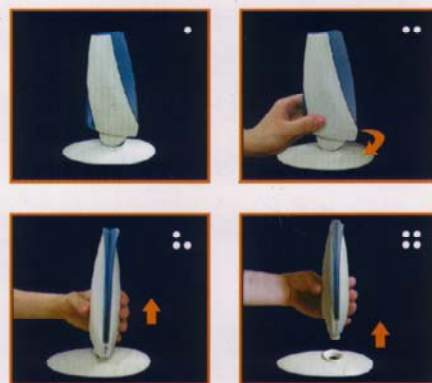

Fig. 4